

- Daily or weekly program
- Dimensions 72 x 72 mm
- Captive setting keys
- Manual override switch Permanent-ON / Permanent-OFF / Automatic
- Analogue display (clock display)

16X 420 (weekly program)

**Highlights**

- Easy programming with captive setting keys
- Easy to read switching program
- Analogue display (clock hands)
- Manual override switch Permanently ON / Permanently OFF / Auto
- Simple to install

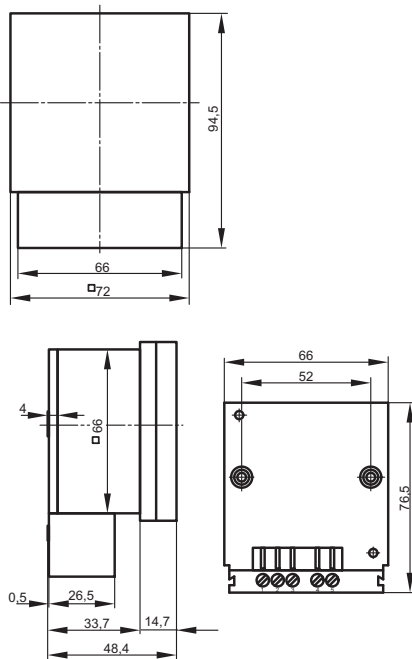

161 X20 / 164 X20

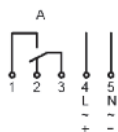

## Analogue Time Switches 161 X20 / 164 X20

for surface mounting and switchboard panel mounting

Technical data	
<b>Voltages</b>	230 V, 50–60 Hz other voltages on request
<b>Power consumption</b> (real power)	0.4 W
<b>Switch</b> (potential-free)	Change-over, contact gap < 3 mm (μ)
<b>Contact material</b>	AgCdO
<b>Switching capacity per channel</b>	16 A / 250 V~ at cosφ=1 2,5 A with inductive load cosφ=0.6
<b>Minimum switching interval</b>	16X 120 day dial 15 min 16X 420 week dial 1 h
<b>Time base</b>	Quartz
<b>Power back-up</b> (at 20°C)	≥ 100 h
<b>Permitted ambient temperature</b>	-10°...+50°C
<b>Enclosure</b>	self-extinguishing thermoplastic
<b>Dimensions</b>	Front frame 72 x 72 mm (DIN EN 43700)
<b>Switchboard panel mounting</b>	Retaining clip
<b>Surface mounting</b>	With plug-in base and terminal cover
<b>DIN-rail mounting</b>	Possible with additional quick-fix retaining clip (120 004) for 35 mm section rail
<b>Type of connection</b>	6.3 mm flat plug or with screw clip when using plug-in base
<b>Type of protection</b>	IP 20 to DIN EN 60529
<b>Class of protection</b>	II when installed according to regulations
<b>Accessory</b> (not included in delivery)	Adapter for DIN-rail mounting 120 004 Clamp for switchband mounting 160001

**Accessories**

Retaining Clip	160.001
Quick-fix retaining clip	120.004

Order number	Version
paladin 161 120	Day without reserve
paladin 164 120	Day with reserve
paladin 161 420	Week without reserve
paladin 164 420	Week with reserve

▼ Housing colour