

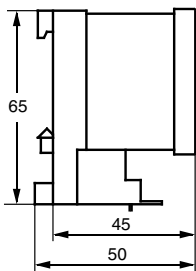

- For DIN-rail and wall mounting
- Flush mount dimensions 45 x 48 mm
- Screw terminals
- No terminal cover
(see accessories for terminal covers)

Elapsed time counters BW 40.88

for DIN-rail or wall mounting · Alternating/Direct Current

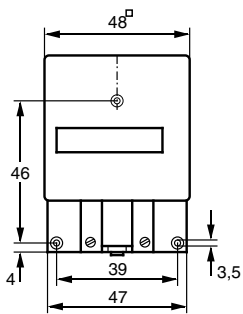

Technical data

Supply voltages (please state when ordering)	230 V, 50 Hz alt. 115 V, 50 Hz alt. 24 V, 50 Hz
Special voltages	on request
Special frequency	60 Hz
Voltage tolerance	±15%
Power consumption	ca. 1.5 VA
Counter capacity	99999 h
Accuracy of reading	0.01 h
Numeral height	4.4 mm
Numeral colour	white, decimal figures red
Operation indicator (without reset)	fast-running wheel
Permitted ambient temperature	-15°...+55°C
Enclosure	self-extinguishing thermoplastic
Type of connection	Screw terminals
Type of protection (DIN EN 40050)	IP 50 to DIN EN 40050
Class of protection	II (when fitted in accordance with regulations)

Rights to technical amendments reserved.

Accessories

Terminal cover	003.007.003
----------------	-------------

Type/Order No.	Version
BW 40.88	Alternating current