

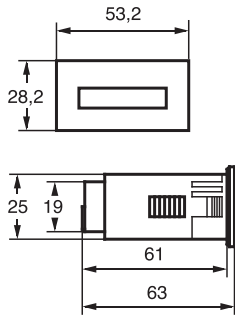

**BW 30.18**

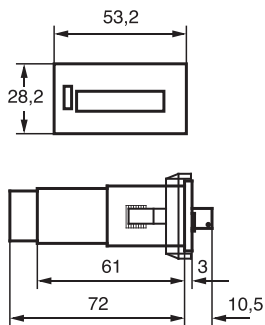

**BW 22.15**



**BW/BG 30:**

- Front panel 53 x 28 mm
- Without zero reset
- Integral locking spring
- With universal connections
- Touch proof connections to VBG 4
- Mounting aperture: 50 x 25 mm

**BW 22:**

- Front panel 53 x 28 mm
- With zero reset button
- Optional reset with key
- With retaining clip
- Mounting aperture: 50 x 25 mm
- Alternating current

**Elapsed time counters BW 30 · BG 30 · BW 22**  
with or without zero reset · Alternating/Direct Current

Technical data	BW 22 BW 30 Alternating current	BG 30.18 Direct current
Supply voltages (Please state when ordering)	(BW 22 only 50 Hz) 230 V, 50 Hz (standard) or 115 V, 50 Hz or 24 V, 50 Hz	12–48 VDC
Special voltages	–	5–24 V, 36–120 VDC, 100–300 VDC
Other voltages	on request	on request
Special frequency	60 Hz (BW 30.18)	–
Voltage tolerance	±15%	±10%
Power consumption (real power)	BW 22.15: 1.1 W BW 30.18: 0.11 W	approx. 20 mW at 12 VDC
Counter capacity with reset (BW 22) without reset (BW 30)	9999 h 99999 h	– 99999 h
Accuracy of reading	0.01 h	0.1 h
Numeral height	4.4 mm	4.4 mm
Numeral colour	white, decimal figures red	white, decimal figures red
Operation indicator (without reset)	fast-running wheel (BW 30.18)	LED
Permitted ambient temperature	–15°...+50°C	–10°...+50°C
Enclosure	self-extinguishing thermoplastic	
Type of connection	Universal: Screw, soldered and 6.3 x 0.8 mm AMP plug-type connections	
Type of protection (DIN EN 60529)	BW 30 Front IP 54 BW 22 Front IP 50	Front IP 54 –
Class of protection	II (when fitted in accordance with regulations) III (up to 48 VDC)	

**Accessories**

- Key for BW 22.15 676.001
- Retaining clip for BW 22/30, BG 30 715.005

Order number	Version
■ BW 30.18	Alternating current, without reset
■ BG 30.18	Direct current, without reset
■ BW 22.15	Alternating current, with reset
■ BW 22.16	Alternating current, with reset and key

✓ Housing colour