

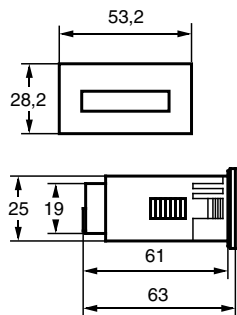

BW 30.18

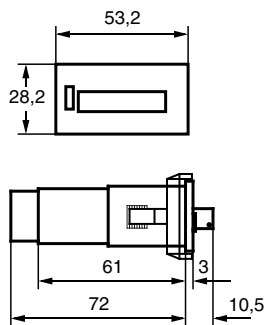

BW 22.15



BW/BG 30:

- Front panel 53 x 28 mm
- Without zero reset
- Integral locking spring
- With universal connections
- Touch proof connections to VBG 4
- Mounting aperture: 50 x 25 mm

BW 22:

- Front panel 53 x 28 mm
- With zero reset button
- Optional reset with key
- With retaining clip
- Mounting aperture: 50 x 25 mm
- Alternating current

Elapsed time counters BW 30 · BG 30 · BW 22
with or without zero reset · Alternating/Direct Current

| Technical data | BW 22 BW 30 Alternating current | BG 30.18 Direct current |
|---|--|------------------------------------|
| Supply voltages (Please state when ordering) | (BW 22 only 50 Hz) 230 V, 50 Hz or 115 V, 50 Hz or 24 V, 50 Hz | 12–48 VDC |
| Special voltages | – | 5–24 V, 36–110 VDC, 100–300 VDC |
| Other voltages | on request | on request |
| Special frequency | 60 Hz (BW 30.18) | – |
| Voltage tolerance | ±15% | ±10% |
| Power consumption | approx. 1.5 VA | approx. 20 mW at 12 VDC |
| Counter capacity with reset (BW 22) without reset (BW 30) | 9999 h 99999 h | – 99999 h |
| Accuracy of reading | 0.01 h | 0.1 h |
| Numeral height | 4.4 mm | 4.4 mm |
| Numeral colour | white, decimal figures red | white, decimal figures red |
| Operation indicator (without reset) | fast-running wheel (BW 30.18) | LED |
| Permitted ambient temperature | –15°...+50°C | –10°...+50°C |
| Enclosure | self-extinguishing thermoplastic | |
| Type of connection | Universal: Screw, soldered and 6.3 x 0.8 mm AMP plug-type connections | |
| Type of protection (DIN EN 60529) | BW 30 Front IP 54 BW 22 Front IP 50 | Front IP 54 – |
| Class of protection | II (when fitted in accordance with regulations) III (up to 48 VDC) | |

Rights to technical amendments reserved.

Accessories

| | |
|------------------------------------|-------------|
| Key for BW 22.15 | 676.001.004 |
| Retaining clip for BW 22/30, BG 30 | 715.005.004 |

| Type/Order No. | Version |
|-----------------|------------------------------------|
| BW 30.18 | Alternating current, without reset |
| BG 30.18 | Direct current, without reset |
| BW 22.15 | Alternating current, with reset |